



engineering art in dimensional metrology



Product Catalogue Ver 1.0
Plain Ring Gauges

Plain & Master Setting Ring Gauges

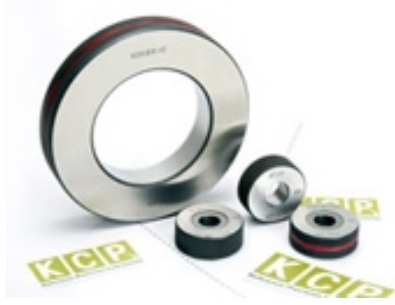

Ring Gauges are ideal for measuring outside diameter of work pieces. A ring gauge is also effective to check out of roundness on the higher side. A master setting ring is used as a standard to set bore gauges, which can then be used to determine deviation from the master size.

 1- 300mm diameter

 Metric & Imperial

 Customisation available

 IS: 3455 (standard for manufacturing tolerance)

 Carbide | Steel

Specifications

Product Information

- We offer a choice of choosing between GO and NO-GO both made in Tungsten Carbide/Steel and GO in Tungsten Carbide with NO-GO in Steel. The latter type is more popular owing to the cost advantage.
- We also manufacture Ring Gauges to relevant I.S., B.S. and DIN standards based on customer requests from 1- 300mm diameter.
- We are also specialize in non-standard designs such as extra lengths, multiple diameters, air grooves, pilots, depth steps and relieved NO-GO ends.

Technical Specifications

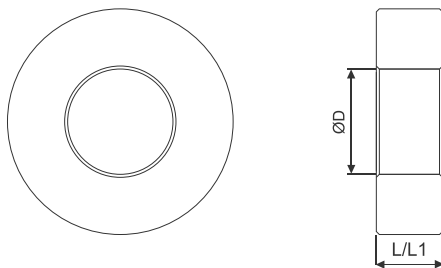

L: Length of Go/NoGo member L1: Length of Master setting ring

Material	Range	Φ 1 – 5	Φ 5-10	Φ 10- 25	Φ 25 – 60
Carbide	L/L1	5/10	10	15	20

* All figures in mm

Unique Features



Features of Plain Ring Gauges

- High Durability
- High Tensile Strength



Certificate No. : C-0432

KCP Plain & Master Setting Ring Gauges are supplied with Calibration Certificate issued from its accredited calibration lab.

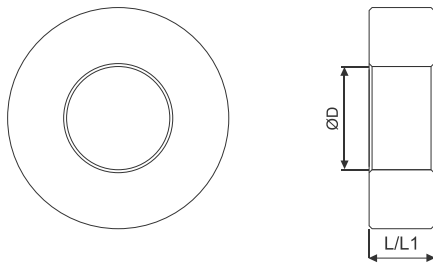

L: Length of Go/NoGo member L1: Length of Master setting ring

Material	Range	Φ 1 – 5	Φ 5-10	Φ 10- 25	Φ 25 - 40	Φ 40 - 60	Φ 60 – 100
Steel	L/L1	5/10	10/15	15/20	20/25	20/30	25/30

* All figures in mm

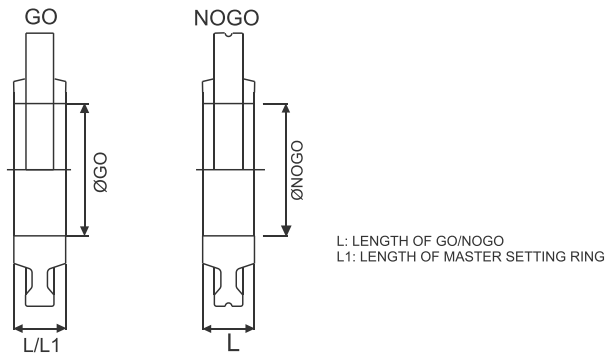

L: LENGTH OF GO/NOGO
L1: LENGTH OF MASTER SETTING RING

L: Length of Go/NoGo member L1: Length of Master setting ring

Material	Range	Φ 100-160	Φ160-190	Φ190-224	Φ224-265	Φ265-300
Steel	L/L1	28/36	32/40	32/45	36/50	36/56

* All figures in mm

precision begins here...



K C Precision

M 107/5/2, MIDC Waluj, Aurangabad 431136 (MS) INDIA. Ph: +91 (0)240 2555895 Telefax: +91 (0)240 2555898

Email: sales@kcpindia.com Web: www.kcpindia.com